

Coachmen Class A Pocket Guide

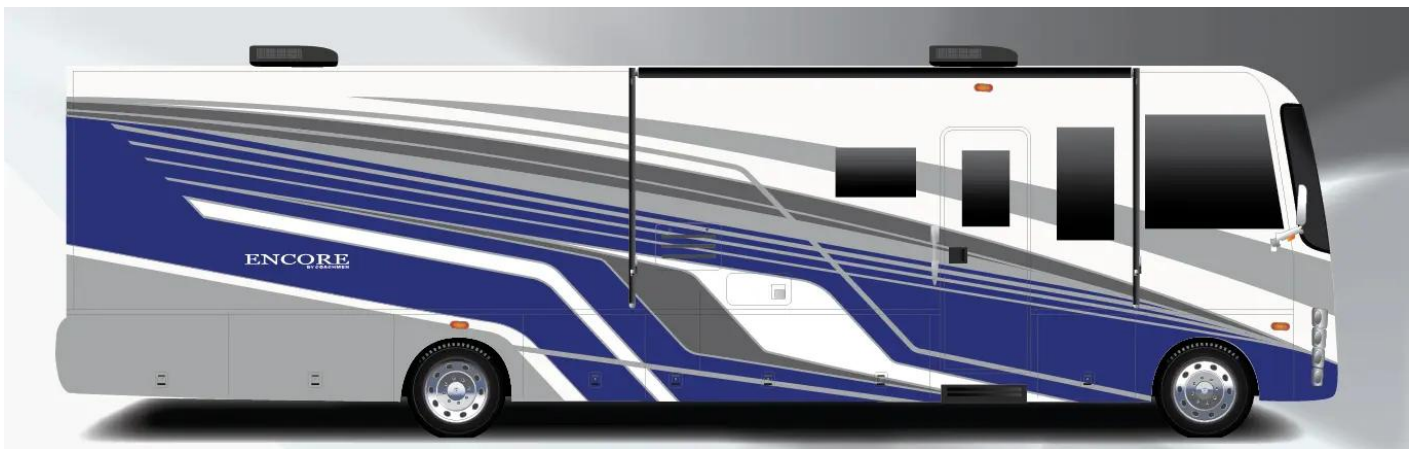

ENCORE

ENCORE

TOP FEATURES

1. **Ford F-53 Chassis**: While Ford is the only Class A chassis available, there are still features to sell. If we sell them and the competition does not...
 - 22K Chassis
 - 7.3L V8 Godzilla Engine
 - 335 HP
 - 468 Lbs. ft. Torque
 - 22.5 Aluminum Wheels
 - Tow Haul Mode
 - Extends shift range.
 - Provides “braking” by downshifting.
 - 80 Gallon Fuel Tank
2. **Azdel** - on both the inside and outside walls - **NO Wood in Sidewall**.
3. **Full Body Paint** (optional) - 6 coats Sikkens Paint w 4 coats clear
4. **200-watt Solar Panel** - up to 16 amps power per hour to maintain battery condition.
5. **Mirrors** - Diesel Style Chrome Mirrors offers improved safety and visibility. Heated and Remote Controlled.
6. **6000 KW NPS Powered Generator** - 50-amp service, enough power to run everything on the motorhome. Also Standard,
 - AGS — Automatic Generator Start - temperature, time, voltage.
 - Fuel Consumption @ ½ load = .041 Gal/Hr.
7. **Automatic Leveling Jacks** - will level the motorhome with the push of a button.
8. **Skylight** - in Living Area with power shade
9. **13.5K BTU A/C's** - Two (2) 13.5K GE High Efficiency Air Conditioners with Heat Pumps - Much quieter than previous A/C's.
10. **Even Cool Ducting™** - CoolStream® ducting “H” layout ties both A/C's to the same ductwork. Antibacterial Coating resist mold and mildew buildup.
11. **Under Bed Storage** - 325SS and 355DS offers a unique feature with additional storage. Includes a mirror, two padded benches, four drawers, shoe racks and pedestal table.
12. **8,000 lb. Rated Hitch Receiver** - fully loaded the 22K chassis will legally tow 4,000 lbs. Calculate how much more the motorhome can tow using GVWR, GCWR and NCC.



Encore

335FS

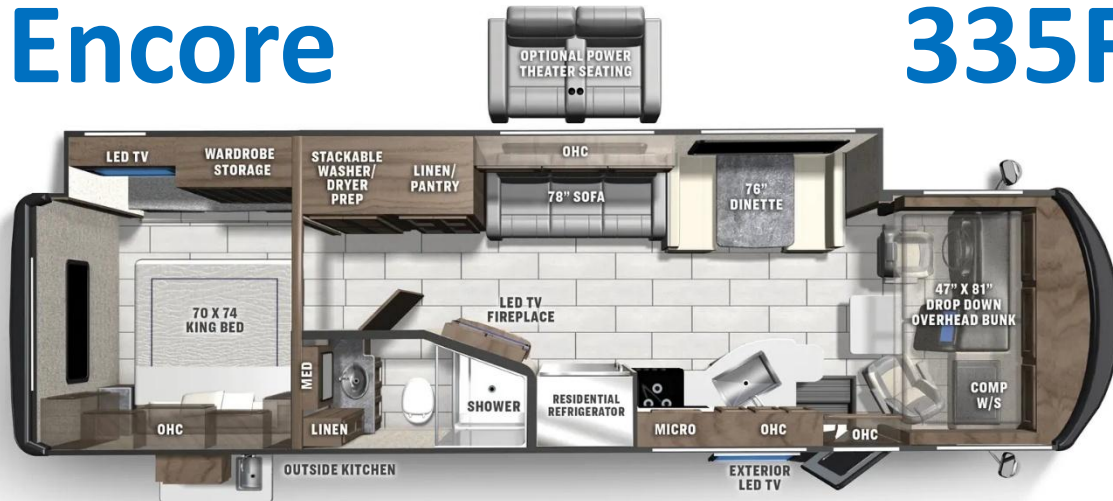

Encore 335FS Features:

- FULL WALL SLIDE
- 1-PIECE FIBERGLASS ROOF
- **AZDEL** SIDEWALL SUBSTRATE BACKER & **AZDEL** INTERIOR WALLBOARD
- 6000 NPS GAS GENERATOR
- MANUAL DROP-DOWN FRONT BUNK
- (2) 13.5 A/C - GE HIGH EFFICIENCY w/ HEAT PUMP
- RESIDENTIAL REFRIGERATOR
- AUTO GENERATOR START (AGS)
- DREAM BOOTH DINETTE
- POWER SKYLIGHT
- LINEN / PANTRY
- 78" Hide-A-Bed SOFA
- ELECTRIC FIREPLACE
- SOFT CLOSING DRAWER GUIDES
- SOLID-SURFACE COUNTERTOPS
- 70" X 74" KING BED W/ STORAGE SYSTEM
- DESIGNATED C-PAP STATION
- OUTSIDE KITCHEN
- LP QUICK CONNECT
- 200-WATT SOLAR PANEL
- PRE-WIRED FOR SATELITTE DISH
- **Options**
 - Full Body Paint
 - Convection Microwave
 - Power Theater Seating
 - Stackable Washer/Dryer

CLASS A GAS	335FS
FORD ENGINE V-8 - 7.3L	335 HP/468 TRQ
WHEELBASE	228"
GVWR	22,000 lbs.
GCWR	26,000 lbs.
GAWR FRONT	8,000 lbs.
GAWR REAR	15,000 lbs.
FUEL CAPACITY	80 gal
LP GAS CAPACITY	84 lb.
FURNACE (BTUs)	30,000
EXTERIOR LENGTH	35' 4 "
EXTERIOR HEIGHT	12' 7"
EXTERIOR WIDTH	102"
FRESH WATER	70 gal
GREY WATER	45 gal
BLACK WATER	45 gal
WATER HEATER	ON-DEMAND
AWNING SIZE	10' & 15'
TOW HITCH RATING	8,000 lbs.

1/8/2026



Encore 355DS

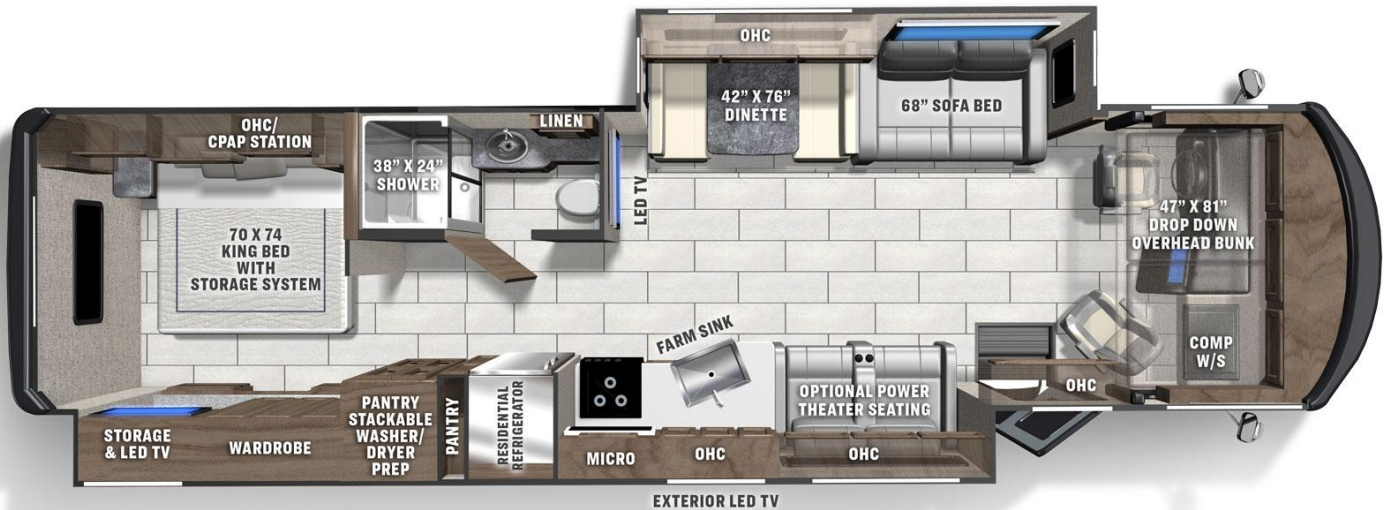

Encore 355DS Features:

- 1-PIECE FIBERGLASS ROOF
- **AZDEL** SIDEWALL SUBSTRATE BACKER & **AZDEL** INTERIOR WALLBOARD
- 6000 NPS GAS GENERATOR
- MANUAL DROP-DOWN FRONT BUNK
- (2) 13.5 A/C - GE HIGH EFFICIENCY w/ HEAT PUMP
- RESIDENTIAL REFRIGERATOR
- AUTO GENERATOR START (AGS)
- DREAM BOOTH DINETTE
- POWER SKYLIGHT
- PANTRY
- 68" (Hide-A-Bed) SOFA & THEATER SEATING
- ELECTRIC FIREPLACE
- SOFT CLOSING DRAWER GUIDES
- SOLID-SURFACE COUNTERTOPS
- 70" X 74" KING BED W/ STORAGE SYSTEM
- DESIGNATED C-PAP STATION
- LP QUICK CONNECT
- 200-WATT SOLAR PANEL
- PRE-WIRED FOR SATELLITE DISH
- **Options**
 - Full Body Paint
 - Convection Microwave
 - Power Theater Seating
 - Stackable Washer/Dryer

CLASS A GAS	355DS
FORD ENGINE V-8 - 7.3L	335 HP/468 TRQ
WHEELBASE	242"
GVWR	22,000 lbs.
GCWR	26,000 lbs.
GAWR FRONT	8,000 lbs.
GAWR REAR	15,000 lbs.
FUEL CAPACITY	80 gal
LP GAS CAPACITY	84 lb.
FURNACE (BTUs)	30,000
EXTERIOR LENGTH	36' 10 "
EXTERIOR HEIGHT	12' 7"
EXTERIOR WIDTH	102"
FRESH WATER	70 gal
GREY WATER	45 gal
BLACK WATER	45 gal
WATER HEATER	ON-DEMAND
AWNING SIZE	20'
TOW HITCH RATING	8,000 lbs.



Encore

375RB

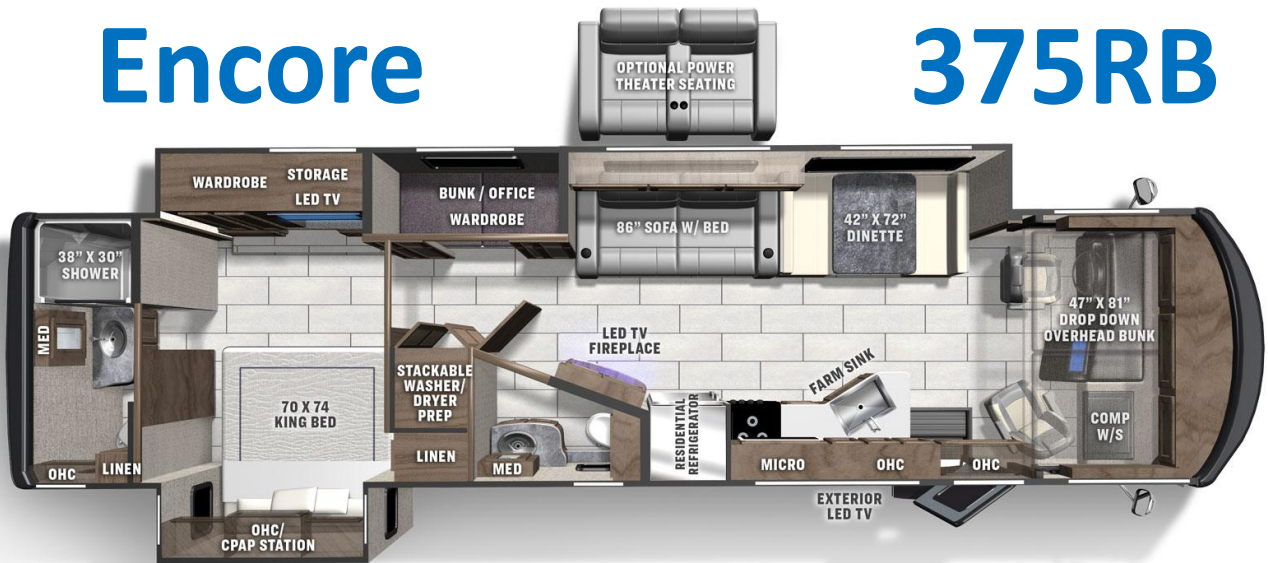

Encore 375RB Features:

- BATH AND A HALF
- 1-PIECE FIBERGLASS ROOF
- **AZDEL** SIDEWALL SUBSTRATE BACKER & **AZDEL** INTERIOR WALLBOARD
- 6000 NPS GAS GENERATOR
- MANUAL DROP-DOWN FRONT BUNK
- (2) 13.5 A/C - GE HIGH EFFICIENCY w/ HEAT PUMP
- RESIDENTIAL REFRIGERATOR
- AUTO GENERATOR START (AGS)
- DREAM BOOTH DINETTE
- POWER SKYLIGHT
- CLOSET / PANTRY
- 86" Hide-A-Bed SOFA
- ELECTRIC FIREPLACE
- SOFT CLOSING DRAWER GUIDES
- SOLID-SURFACE COUNTERTOPS
- 38" x 30" SHOWER
- 70" X 74" KING BED
- DESIGNATED C-PAP STATION
- LP QUICK CONNECT
- 200-WATT SOLAR PANEL
- PRE-WIRED FOR SATELLITE DISH
- **Options**
 - Full Body Paint
 - Convection Microwave
 - Power Theater Seating
 - Stackable Washer/Dryer

CLASS A GAS	375RB
FORD ENGINE V-8 - 7.3L	335 HP/468 TRQ
WHEELBASE	242"
GVWR	22,000 lbs.
GCWR	26,000 lbs.
GAWR FRONT	8,000 lbs.
GAWR REAR	15,000 lbs.
FUEL CAPACITY	80 gal
LP GAS CAPACITY	84 lb.
FURNACE (BTUs)	30,000
EXTERIOR LENGTH	38' 2 "
EXTERIOR HEIGHT	12' 7"
EXTERIOR WIDTH	102"
FRESH WATER	70 gal
GREY WATER	90 gal
BLACK WATER	45 gal
WATER HEATER	ON-DEMAND
AWNING SIZE	20'
TOW HITCH RATING	8,000 lbs.

1/8/2026