

Mirada Sales Training

* 2023



Partial Paint w/Graphics



Glaucous



Graphite



Scarlet



SCAN HERE

To see available
Standards, Options
and Features!

MIRADA

BY COACHMEN



Table of Contents

<u>Page 3</u>	<u>Interior Decors</u>
<u>Page 4-5</u>	<u>Floorplans 29FW, 32LS, 315KS, 35OS & 35ES</u>
<u>Page 6</u>	<u>Specifications</u>
<u>Page 7</u>	<u>Floor Construction</u>
<u>Page 8-10</u>	<u>Sidewall Construction</u>
<u>Page 11</u>	<u>Roof Construction</u>
<u>Page 12 -13</u>	<u>Air Conditioner & Heat pump</u>
<u>Page 14</u>	<u>Ford Chassis/Powertrain</u>
<u>Page 15</u>	<u>Towing</u>
<u>Page 16 -17</u>	<u>Generator</u>
<u>Page 18 -21</u>	<u>Exterior Features</u>
<u>Page 22 -32</u>	<u>Interior Features</u>
<u>Page 33-34</u>	<u>HDTV Antenna/HD Smart TV</u>
<u>Page 35</u>	<u>Warranty</u>
<u>Page 36</u>	<u>Owner's Manual</u>
<u>Page 37</u>	<u>History of Coachmen</u>
<u>Page 38</u>	<u>Service & Parts contacts</u>
<u>Page 39</u>	<u>Coachmen salesperson Contact</u>

MIRADA

BY COACHMEN

Interior Decors



Chocolate Cherry



White Velvet



Primary Fabric (Sofa & Dinette)



Secondary Accent color



Valance Fabric



Wallboard

Linen



Primary Fabric (Sofa & Dinette)



Secondary Accent color



Valance Fabric



Wallboard

Onyx

MIRADA

BY COACHMEN

Floorplans

29FW



32LS

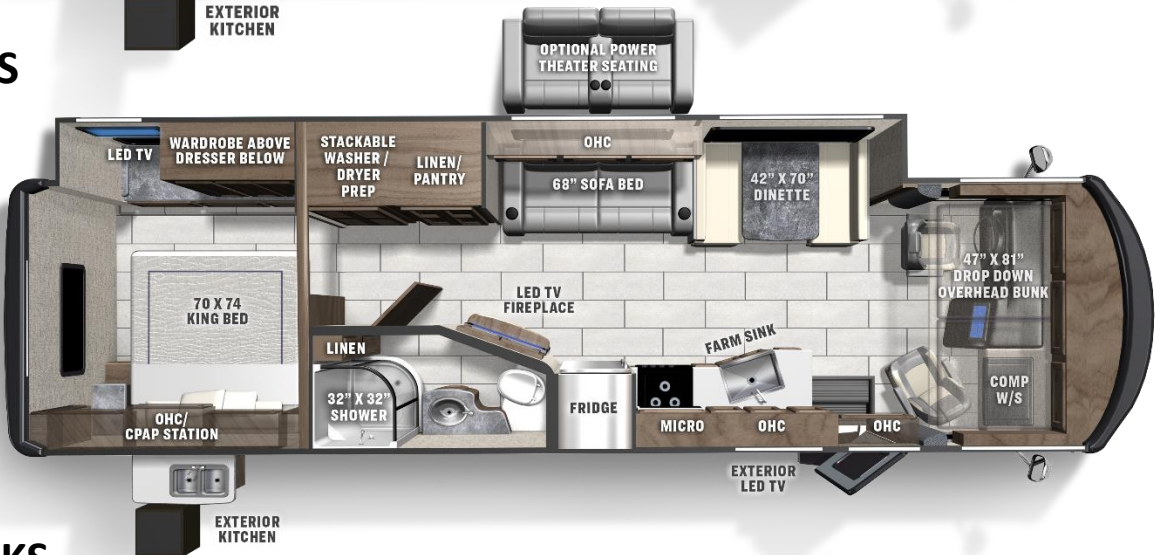

315KS



350S

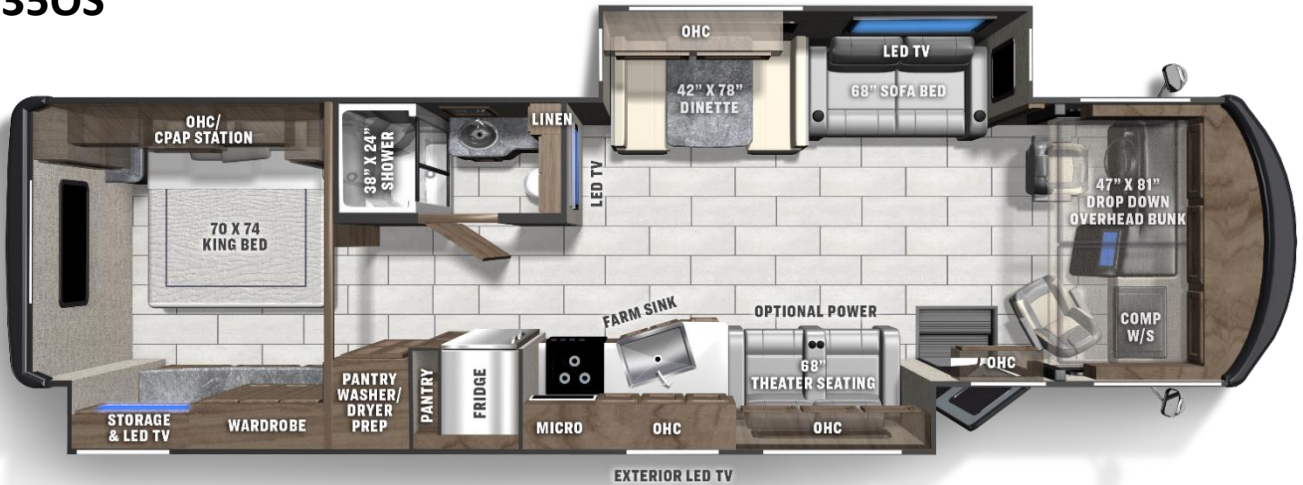

35ES

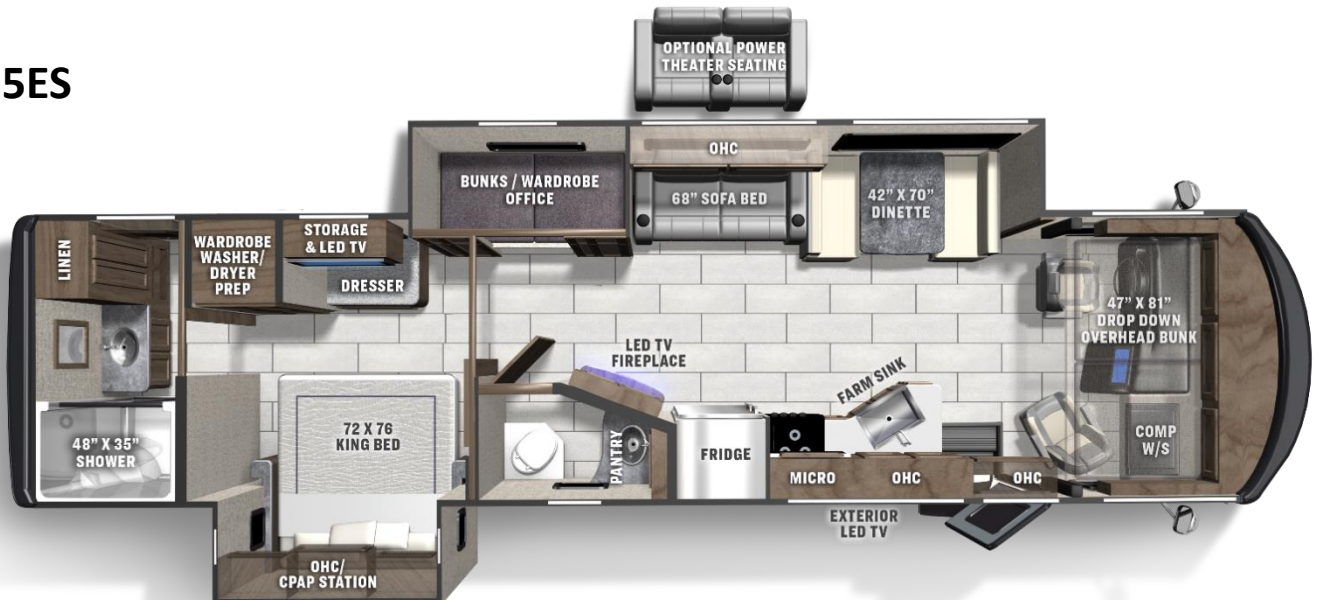

MIRADA SPECIFICATIONS

CLASS A GAS	29FW	315KS	32LS	35ES	35OS
FORD ENGINE V-8 7.3L 3-VALVE	350 HP/468 TRQ	350 HP/468 TRQ	350 HP/468 TRQ	350 HP/468 TRQ	350 HP/468 TRQ
WHEEL BASE	190"	228"	228"	242"	242"
GVWR	18,000 lbs	22,000 lbs	20,500 lbs	22,000 lbs	22,000 lbs
GCWR	23,000 lbs	26,000 lbs	26,000 lbs	26,000 lbs	26,000 lbs
GAWR FRONT	7,000 lbs	8,000 lbs	7,500 lbs	8,000 lbs	8,000 lbs
GAWR REAR	12,000 lbs	15,000 lbs	13,500 lbs	15,000 lbs	15,000 lbs
FUEL CAPACITY	80 gal	80 gal	80 gal	80 gal	80 gal
LP GAS CAPACITY	20 gal	20 gal	20 gal	20 gal	20 gal
FURNACE (BTUs)	30,000	30,000	30,000	30,000	30,000
EXTERIOR LENGTH (w/o Ladder)	30' 7"	33' 1"	34' 10"	36' 10"	36' 10"
EXTERIOR HEIGHT (w/A/C)	12' 5"	12' 7"	12' 5"	12' 5"	12' 5"
EXTERIOR WIDTH	102"	102"	102"	102"	102"
FRESH WATER	50 gal	70 gal	70 gal	70 gal	70 gal
GREY WATER	46 gal	46 gal	45 gal	45/45 gal	45 gal
BLACK WATER	46 gal	46 gal	45 gal	45/46 gal	45 gal
WATER HEATER	6 gal	10 gal	6 gal	6 gal	6 gal
AWNING SIZE	20'	8' & 12'	15' & 10'	17'	20'

MIRADA

BY COACHMEN

Floor

5-Layer Laminated Construction

1. Galvanized Steel Underbelly

- Coated with Zinc Oxide to prevent metal from rusting and is harder to scratch
- Helps keep rodents and other pests from gaining access to interior

2. 1½" Welded Tubular Steel Framing

- 1-1/2" Welded tubular steel framing
- 3" X 8" metal plates welded at 24" intervals over the Heat Duct channels. Stronger than aluminum (aluminum is a low-density metal and when used in structures it is more prone to vibrations and bending compared to steel)

3. 1½" High Compression Block Foam Insulation

- Increases R-Value and insulation of motorhome. 2 lb. per inch High Density Polystyrene foam insulation. Thicker block foam than many other manufacturers providing better insulated RVs

4. ½" Floor Decking

- 2 layers of ¼" decking with staggered seams
- Staggering seams prevents dead spots and air gaps since no seams run through entirety of floor

5. Linoleum (SHAW Flooring)

- Slip Resistant
- Stain Resistant
- Cold Crack Resistant
- Resistant to Mold and Mildew

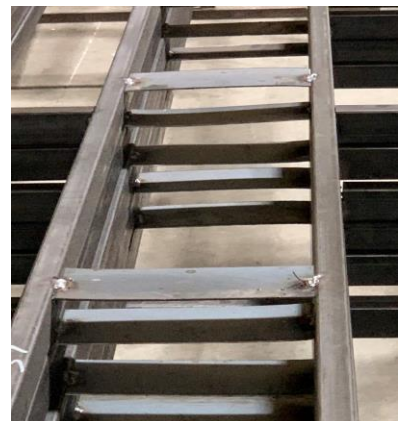
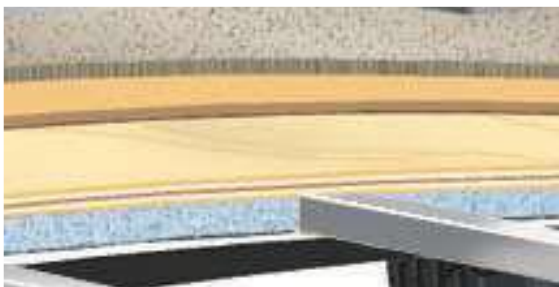

MIRADA

BY COACHMEN

Sidewalls

5-Layer Laminated Construction

1. Fiberglass Exterior Skin

- Noble Select High gloss sidewall with gel coat.
- These come to us bonded together in long flat sheets that are then laminated to our sidewall.
- 3 Year warranty

2. AZDEL Composite Substrate Backer

- 50% lighter than wood
- Made in the USA
- Impervious to water, rot, or mold damage
- 3X the insulation value of wood



3. 1½" High Compression Foam Insulation

- Increases R-Value and insulation of motorhome.
- 1.5 lb. Rigid Foam insulation
- Thicker foam than many other manufacturers providing better insulated RVs

4. 1½" Aluminum Framing with Electroplated Galvanized Steel Backing (EGS)

- Aircraft grade welded aluminum framing.
- Aluminum framing around entry door, windows and appliance openings.
- Electroplated Galvanized Steel (EGS) backing provides anchoring for cabinets and other heavy objects hung from

5. Interior décor wallboard

- Residential looking



Azdel Composite Panels - Key Features

Weight Matters™  50% Lighter Than Wood for Lighter RVs	Let It Rain™  Impervious to Water: No Rot, Mold or Water Damage	from Sweats to Chills™  3X the Insulation Value of Wood
 Odorless, Formaldehyde Free	 Sound & Energy Absorbing for Quieter RVs	 Impact & Puncture Resistant: Stronger Sidewalls Help Prevent Damage

MIRADA

BY COACHMEN

If Our Walls Could Talk

Starts with **Noble Select** Sidewall gel coat exterior, which is thicker than most competitors and offers a three-year warranty through our supplier...

Our Walls are Vacuum-bonded AND pinch-rolled for maximum adhesion!

Within the walls, the **Noble Select** is adhered to **AZDEL** composite panels, which are a blend of polypropylene and fiberglass...

AZDEL is...

- HALF the weight of wood!
- IMPERVIOUS to water!
- FORMALDEHYDE free and odorless!
- THREE times the insulation of a wood panel!
- RAISES the R-Value 2 points!
- ABSORBS sound for a quieter ride!
- More IMPACT resistance – tends to flex rather than staying rigid so it doesn't crack
- NOT WOOD – wet wood causes panel delamination and Separation

Aluminum structure is DOUBLE-WELDED at the joints!

Metal EGS Backers for secure anchoring points of cabinets

MIRADA

BY COACHMEN

Noble Select

SIDEWALL FINISH TYPES	SURFACE FINISH QUALITY	DENT / TEAR RESISTANCE	REPAIRABILITY	SCRATCH RESISTANCE	MAINTENANCE	NONCORROSIVE RESISTANCE	WARRANTY
FILON® G-III	MEDIUM	HIGH	HIGH	HIGH	LOW	HIGH	2-YEARS PARTS & LABOR
CRANE GOLD	HIGH	HIGH	HIGH	HIGH	LOW	HIGH	2-YEARS PARTS & LABOR
NOBLE® CLASSIC	HIGH	HIGH	HIGH	HIGH	LOW	HIGH	1-YEAR PARTS & LABOR
NOBLE® SELECT	PREMIUM	HIGH	HIGH	HIGH	LOW	HIGH	3-YEARS PARTS & LABOR
PAINTED ALUMINUM	HIGH	LOW	LOW	LOW	MEDIUM	HIGH	RV MFG WARRANTY

Mirada uses Noble Select Sidewalls

The Noble Select sidewalls have a High Gloss gelcoat finish that will prevent fading and help maintain its look for years to come. They have 3X the insulation properties and are 20% lighter than wood substrate sidewalls. This creates more cargo carrying capacity in our motorhomes and allow them to be used in more extreme climates. Noble Select sidewalls come with a 3 year warranty unlike most other sidewalls with a 1 or 2 year warranty. Most other manufactures uses Noble Classic sidewalls that have a Luan backer

MIRADA

BY COACHMEN

Roof

5-Layer Laminated Construction

1. **Interior Ceiling Board**
2. **Rigid Polystyrene Foam Insulation**
 - 2 lb. per inch High Density foam insulation.
 - The insulation is routed out for the CoolStream A/C Ducting to be installed.
 - Virtually impervious to moisture
 - Provides great insulation properties
3. **Aluminum Rafters**
 - Crowned for controlled water run off
 - Can withstand considerable amounts of weight
 - Impervious to water damage
4. **Plywood Roof Decking**
 - Strengthens roof
5. **One-Piece Fiberglass Roof**
 - Easy to clean
 - No seams run down the middle
 - Long lasting
 - 2 Year Warranty on skin

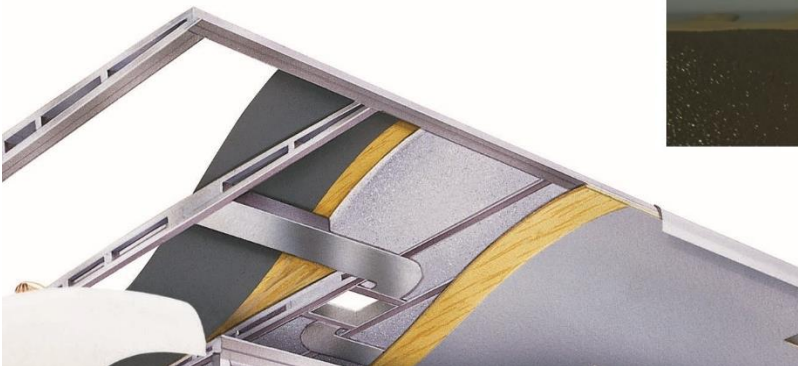

MIRADA

BY COACHMEN

Even-Cool / Cool-Stream Ducting

The Mirada comes standard with dual 15,000 BTU A/Cs with heat pump air conditioning units, and a 5.5 kw NPS Yamaha powered gas generator.

The Mirada has Even Cool / CoolStream® residential ducting. This is an air conditioning system that is ducted through the crowned, vacuum-bonded roof. The system is insulated ductwork with an antibacterial coating that resist mold and mildew build-up. Radius corners provide maximum efficiency. Feature: Even Cool™ Air Conditioning System

Benefit: Residential ducting offers radiused corners to ensure maximum, consistent airflow through the A/C ducts. The ductwork is lined with an antibacterial film to resist mold and mildew build-up. Best system for customers with allergies.

Other Motorhome manufacturers utilize molded block Styrofoam insulation for their airflow. Styrofoam is comprised of thousands of miniscule circular beads that have microscopic pores. Over time, those pores will accumulate dust particles. Air conditioning is nothing more than displacing moisture from the inside of the coach and transferring it to the outside which means moisture flowing freely through the coach and interacting with dirt and dust. Over time, this can have an adverse affect, especially for customers that are very sensitive to allergies.



Coachmen Ducting

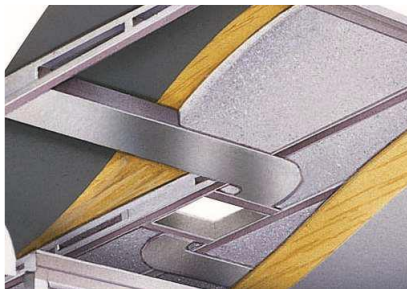

Vs.



Competition Ducting

HOW DOES A HEAT PUMP OPERATE?

- These are two diagrams side by side of how the two systems function:
 - Air Conditioner as a **cooling** unit on the left
 - Air Conditioner as a **heating** unit on the right
- Notice the compressor drawing in both the cooling and heating modes

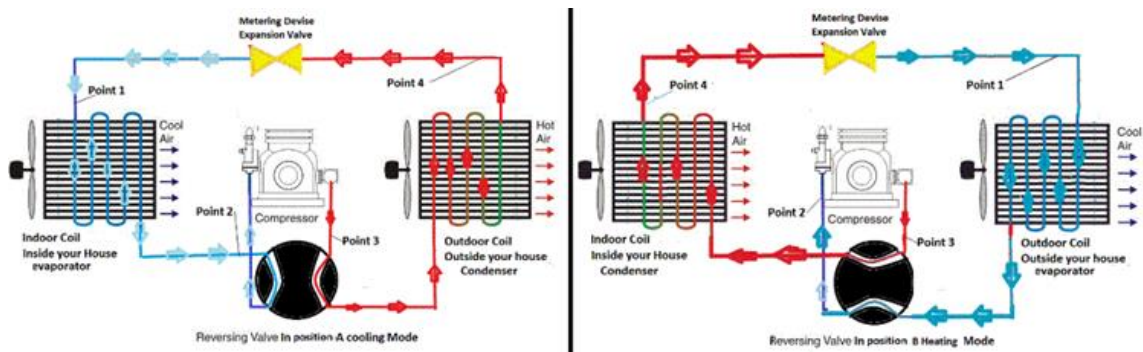

The reversing valve Rotates 90°. This changes the direction of the flow of the refrigerant. It goes in the opposite direction and this is the reverse of the cooling cycle. Instead of absorbing heat from inside the motorhome it absorbs heat from the air outside the motorhome and transfers that heat to the interior. Now the indoor coil has become Condenser and the outdoor coil has become Evaporator

Notice that the heat isn't generated by a gas furnace. It is just moved (or pumped) from the outside air to inside the motorhome. This is why the Heat Pump is so popular in moderate climates. It also functions effectively in colder climates when the outside temperature is 38° to 40° or warmer. You don't need to operate the furnace when the weather cools off. Because of the reversing valve you can use the same electric system as both an air conditioner and a heater!

MIRADA

BY COACHMEN

Ford Chassis / Powertrain

The Mirada is built on a Ford Chassis

- Ford 7.3L **2-Valve Triton** V8 gas engine
 - 350 Horsepower & 468 lbs.-ft. of torque
- Front and Rear 4-Wheel anti-lock disc brakes
- **6-Speed Automatic** Double Overdrive Transmission
 - 3-5% better gas mileage than 5-speed transmission
 - Lower RPMs = quieter in cockpit

Upgrades from the V10 to V8 Ford Chassis

- ABS Braking (Helps stop sooner)
- Upgraded springs (Helps improve ride)
- Hill Start Assist (Prevents rolling backwards on steep hills)
- New instrument cluster / updated wheel and column (Increase look)
 - 9% more HP; 2% more Torque than the V10
- **Premium Sachs Twin Tube Front and Rear shock absorbers**
 - Road jolts and shocks are reduced even further by the addition of front and rear variable-rate jounce bumpers
 - The Sach Twin Tube shock absorbers are found on Rolls Royce, Mercedes Benz, and Maserati.
- **Robust Steering and 50 degree wheel cut (19.5" Tires)**
- Coachmen orders chassis from Ford with **longer wheelbases** than the competition
 - Longer wheelbase causes more weight to exist between axles and less overhang resulting in smoother ride
 - Great Carrying capacity



MIRADA

BY COACHMEN

Determining the Towing Capacity

Every Mirada motorhome has a tow hitch rated at either 5,000 lb. or 8,000 lb. That **DOES NOT** mean it can tow 5,000 lbs. or 8,000 lbs. The tow capacity of a **fully loaded** motorhome is determined by subtracting the Gross Vehicle Weight Rating (GVWR) from the Gross Combined Weight Rating (GCWR).

Example: 22,000 lb. GVWR and 26,000 lb. GCWR has a capacity of 4,000 lbs.

So, how much weight beyond this rating can a motorhome tow?

Load the motorhome as it will be used and have it weighed. The difference between the actual weight and the GVWR will determine how much more the motorhome may safely tow.

Regardless of the hitch rating, always calculate the safe tow capacity of the motorhome, **NEVER Exceeding the Hitch Rating, the Gross Vehicle Weight Rating (GVWR) or the Gross Combined Weight Rating (GCWR).**

	Hitch Rating(lbs.)	GCWR (lbs.)	GVWR (lbs.)	OCWC (lbs.) (Approx.)	Avg. Weight of People and Items in RV (lbs.) (Approx.)	Tow Capacity (lbs.) (Approx.)
Mirada						
29FW	5,000	23,000	18,000	1,800	1500	5000
32LS	8,000	26,000	20,500	3,000	1500	7000
35ES	8,000	26,000	22,000	4,000	1500	6500
315KS	8,000	26,000	22,000	4,000	1500	6500
35OS	8,000	26,000	22,000	3,200	1500	5700

Full Body Paint adds roughly 300 lbs.
OCWCs are approximates for partial paint Mirada's

NPS Generator

KEY FEATURES AND BENEFITS OF OUR GENERATORS:

- PARTNERED WITH AND POWERED BY **YAMAHA**
- 3 YEAR/ 2,000 HOUR WARRANTY
- UP TO 50% MORE FUEL EFFICIENT THAN THE COMPETITION WITH **eco**
- PURE SINE WAVE INVERTER TECHNOLOGY
- ON DEMAND VARIABLE SPEED POWER
- INTEGRATED PULL START
- REMOTE START W/ KEY FOB
- ADVANCED ALL NEW COOLING SYSTEM
- LARGEST NETWORK OF SERVICE LOCATIONS IN THE INDUSTRY

FROM ALL OF US AT **NEXT-GEN POWER SYSTEMS**, WE WOULD LIKE TO THANK YOU FOR YOUR SUPPORT. WE PRIDE OURSELVES ON CUSTOMER SERVICE AND BELIEVE IN EXCEEDING CUSTOMER EXPECTATIONS IN EVERY WAY POSSIBLE. PLEASE DON'T HESITATE TO CALL, WE ARE HERE FOR YOU AND ONLY BECAUSE OF YOU. WE HOPE YOU ENJOY YOUR NEW GENERATOR, HAPPY CAMPING!!!



N.P.S. COMPANY, LLC WWW.NPSRVPOWER.COM

WESTERN HQ: 268 W. STATE STREET SUITE B. HURRICANE UT 84737

EASTERN HQ: 3416 COUNTY ROAD 6 UNIT 2, ELKHART, IN 46514

T: (866) 407-1727

MIRADA

BY COACHMEN

NPS GENERATOR



Inverter Technology

Our generators are unlike anything that has ever been released on the market. The biggest single differentiator is the use of Inverter Technology on our unit. Our proprietary inverter uses a 5% pure sine wave that allows for cleaner, more efficient, stable power. This is the first time inverter technology will be available for RV onboard power generation. A generator with an inverter still produces AC electricity, just like a conventional generator. However, a rectifier is used to convert the AC electricity to DC power, and the DC power is “cleaned” and “smoothed” out by capacitors. In the final step giving this technology its name, the DC power is then converted back into clean AC power, resulting in consistent, reliable, “clean” power!

Why Purchase Inverter Technology

Inverter technology is widely recognized for offering cleaner, more stable power. In the electronic age, this couldn't be more important as many new electronic devices are using microprocessors, which are sensitive to the type of power used. When using unclean power, you run the risk of damaging the device or facing user errors/malfunctions. Your laptop, phones, gaming consoles, blue-ray players, and now kitchen devices will benefit substantially from the use of inverter technology. The result is more efficient power use and cleaner power!

MIRADA

BY COACHMEN

Exterior Features



Radius trunk doors with slam latch

- 1.5" thick slam latch doors (Thicker doors allow for larger openings)
- Side radius doors allow for easier opening of doors and access to items
- Pass-through storage allow for storage of larger / longer items
- Steel Storage compartments with Ozite liner (longer lasting than Rotocast)



Allowing for greater visibility

Dash is angled 20 degrees

MIRADA

BY COACHMEN

Exterior Features

LED Light Under Awning

- An LED light strip is standard. It is attached under the awning and will illuminate the camping area.
- All Slides have awning toppers to protect from weather and debris



TPS – Tire Pressure Monitoring System

- Tire pressure monitoring system that uses TPMS sensors to monitor the air pressure inside the individual tires.
- Reports real-time tire pressure information to the driver.

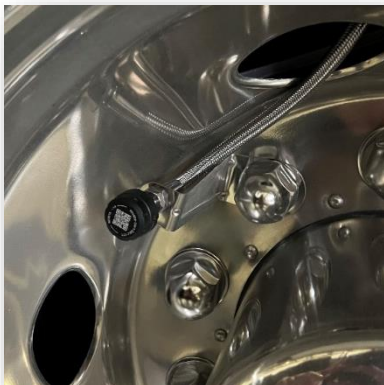

MIRADA

BY COACHMEN

Exterior Features



Tread Lite Power Step

- Lightweight, heavy-duty motor
- Weatherproof components
- Stylish aluminum treads
- LED lighting
- Smoother operation
- Firmer, more stable step



Side View and Rear View Camera

- Strategically-placed side cameras that virtually eliminates the lower blind spot
- Color Infrared side cameras allows great visibility night or day



Heated Enclosed Holding Tanks

- Areas in the exterior storage where tanks and other plumbing is located has forced air heat from the furnace
- Allowing for campers to camp in colder climates
- 29FW does not have forced air heating. Instead it has 12V heat pads and is fully enclosed

Exterior Features

SOLAR

- Each Mirada has a 100-Watt solar panel on the roof
 - Provides 8-12 amps of power per hour
- Customers can upgrade to 300-Watt panel aftermarket
 - **Bulk Charge**, battery voltage has not yet reached boost voltage and 100% of available solar power is used to charge the battery
 - **Boost Charge**, when the battery has recharged to the boost voltage setpoint, constant – current regulation is used to prevent heating and excessive battery gassing.
 - **Float Charge**, after the battery is fully charged in Boost voltage stage, the controller reduces the battery voltage to Float voltage set point. When the battery is fully recharged, there will be no more chemical reactions and all the charge current transmits into heat and gas at this time.

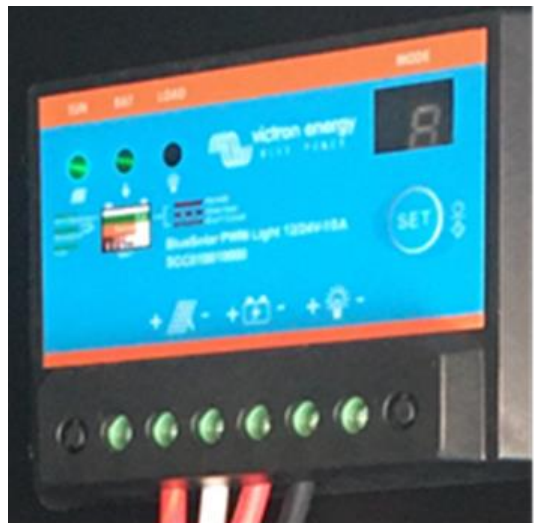

MIRADA

BY COACHMEN



Linen with Chocolate Cherry Wood



Interior Features



Manual Drop-Down Bunk

- Manual bunk will hold 500 lbs.
- Mattress pad is included
- Bunk ladder and mesh net are included for safety



Monitor System

- 10" touch screen monitor that displays the rear and side camera system.
- Includes FM/AM, Bluetooth, and XM radio ready with subscription
- Equipped with Apple and Android CarPlay



Pull Out Computer Desk

- Allows for the passenger to navigate and work while traveling down the road
- Includes USB port, 12V outlet and 110V outlet



New USB Charging Ports on Dash

MIRADA

BY COACHMEN

Interior Features



Mirada 35ES

- Converts to a Wardrobe, Office or Bunk Beds
- The office space provides a chair, desk, electronic hook ups
- When converted to a wardrobe allows for extra closet space with clothes rod
- Bunk Beds are more spacious than most bunk houses - 30"x72"

Interior Features



Self Closing Drawer Guides

- Drawers will not shut violently decreasing chance of damage
- Drawers lock stronger when close and decrease the chance of flying open while in transit



Theater Seating

- Optional Power Theater Seating is now available in the 32LS, 350S, 35ES, 315KS.
 - Power will have Heat, Massage, Light, power recline function
- Equipped with a center console for TV remotes and cup holders



Sofa Hide A Bed

- Sofas will have a hide-a-bed that ranges in size depending on the sofa size and floor plan

MIRADA

BY COACHMEN

Interior Features



Rubber Diamond Plate

- No carpet under the driver or passenger seats allow for easy cleaning in the cockpit
- The rubber diamond plate in the driver cockpit area will hold up longer than linoleum or carpet



SHAW Flooring

- The floor in the Mirada is slip resistant
- Stain resistant
- 3-year no crack warranty
- Resistant to mold and mildew



Reclining/Swivel Pilot Seats

- Both Pilot and Passenger seats will swivel to become additional seating in the motorhome

Interior Features



Glass Tile Backsplash

- Provides a high-end residential appearance
- Easier to clean and maintain than wallpaper or laminate



Stainless Steel Package

- All Stainless-Steel appliances
- 30" residential microwave
- Three Burner Range, Range Cover and Oven
- Refrigerators range in size from 10 cu ft to 18 cu ft depending on the floor plan



Kitchen Prep Area

- Farmhouse Stainless Steel sink
- High Rise Faucet
- Solid surface countertop
- Solid surface sink covers allow for more usable countertop space

MIRADA

BY COACHMEN

Interior Features



Visionary Hide-A-Bed Sofa

- The Hide-A-Bed sofa can easily be made
- No air mattress required
- Storage exist under the sofa cushion allowing for bedding storage and other items
- Two adults can sleep on pull out



Furniture

- Furniture package was upgraded by 25% to increase comfort
- Vinyl package was also upgraded to increase longevity of sofa (5-year hydrolysis)
- Fabric for dinette back cushions to provide more eye appeal



Bathroom

- The bathroom has glass shower doors
- Porcelain Toilet w/Foot Flush
- Stainless steel sink in the bathroom
- Lots of storage in bathroom and some floor plans offer a half bath (35ES)

MIRADA

BY COACHMEN

Interior Features



Full Storage Under Bed

- The Mirada has full storage under the bed
- The bed easily folds up and down because it is supported with hinges
- You can walk around both sides of the bed in the Mirada



Bedroom TV has Hidden Storage

- The TV opens for additional storage behind
- Great place for valuables and other items



Layered Cabinets / Designer Headboard

- The layered cabinets provide additional storage in the bedroom
- Reading lights are located under the cabinets
- 110V outlets are on both sides of the bed

Interior Features



Pantry

- Most Mirada floor plans have a Pantry that will accommodate food and other storage items.

- The Mirada 32LS, 315KS, 35ES and 35OS will have a storage area that will convert to accommodate an optional stackable washer/dryer.
- The above floor plans are pre-plumbed with the electric and plumbing for the washer/dryer. It can be found in a false compartment at the back of the storage area.



MIRADA

BY COACHMEN

Interior Features



Coach Pap Station

- The C-Pap station allows C-PAPs and other devices to be plugged into an outlet in the cabinet above the bed and run the supply hose through the bottom of the cabinet



AGS

- Automatic Generator Start (N/A 29FW)
- Programmable to start the generator based on either:
 - Time
 - Voltage
 - Temperature

Fireplace

- The Mirada 32LS, 35ES and 35OS come with an electric fireplace
- The fireplace acts as a space heater and runs off electric.
- Provides up to 5,000 BTUs
- 1500 Watts
- Runs off 120V, 60Hz



MIRADA

BY COACHMEN

Interior Features



Batteries are located under the steps

- (2) House batteries are standard on the Mirada
- Located under the steps make them easily accessible
- Batteries are protected from road decay



Dual A/Cs, 50 Amp Service

- Mirada is standard with 50 Amp service & Dual 15,000btu A/Cs
- Allow for cooler temperature in summer heat
- NPS 5.5 kw generator is quieter and more efficient than a 4.0 kw generator



Heat pumps

- 15,000 BTU A/C's with Heat Pumps are Standard in the front and rear.
- A Heat Pump will heat the motorhome without having to run the L/P furnace
- Provides heat for the motorhome when the outside ambient temperature is above 25°

MIRADA

BY COACHMEN



KING Jack – digital HDTV antenna system



Wider reception range

- Less directional than traditional RV antennas to provide broader reception coverage

Greatly improved UHF reception

- Superior reception of UHF signals where over 80% of new DTV channels are broadcast, also offers great reception of remaining VHF channels

Fixed height- 8.5" tall

- No need to crank up, can't forget to crank down
- Not affected by ice or snow build-up on roof
- Lower than A/C unit or satellite dish
- Compatible with mobile DTV reception

Environmentally protected

- No periodic lubrication of roof mounted components
- No exposed coaxial cables or connectors

2 year parts, 1 year labor warranty

Adjustable for different roof thicknesses

- 1" to 8" roofs without any cutting or gluing

Compact, aerodynamic design

- 70% smaller and lighter than Batwing antennas



In order to get Radio or TV reception your booster must be turned on at your control monitor panel

MIRADA

BY COACHMEN

Insignia

HD Smart TV
Now in all Mirada Motorhomes

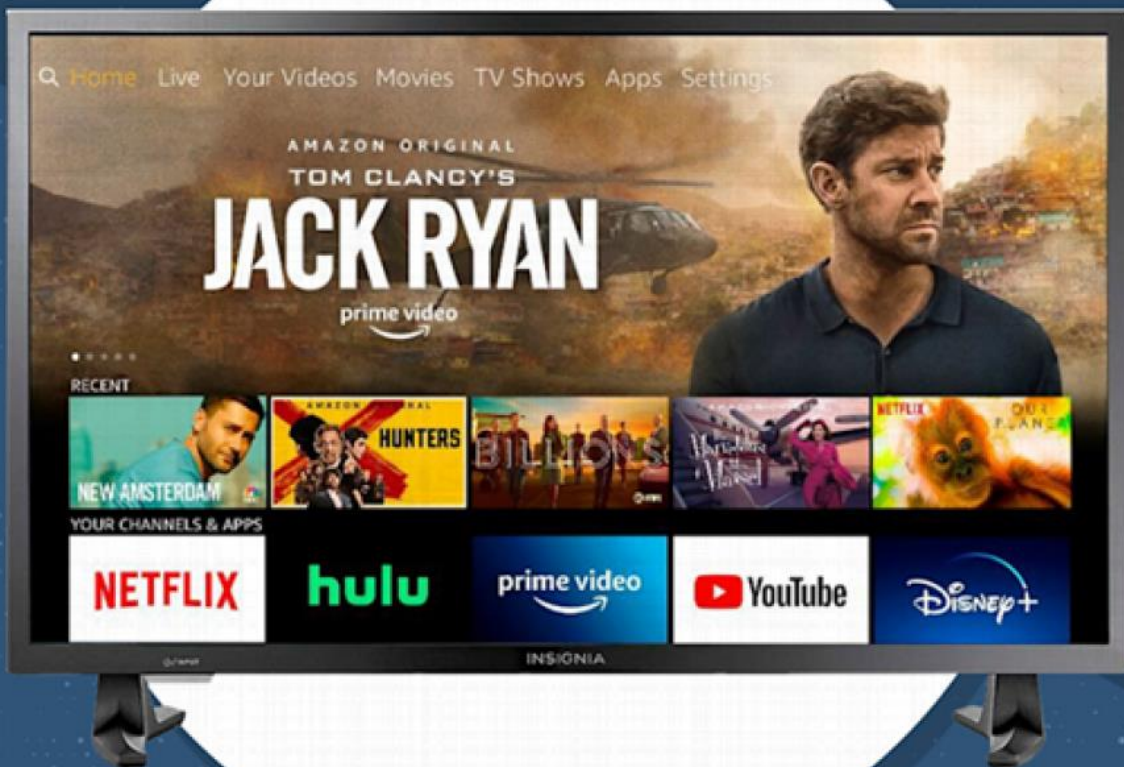

Coachmen Digital Owner's Manual



Coachmen

ACCESS YOUR OWNER'S MANUAL ON OUR WEBSITE OR MOBILE APP!

Customer Satisfaction is our #1 Priority. With that in mind, we have created an *interactive owner's manual* to enhance your ownership experience.

YOUR INTERACTIVE OWNER'S MANUAL FEATURES INCLUDE:

- A Convenient Means to Get Information About Your Product... Immediately
- Access the Entire Owner's Manual & Much More... Anywhere, Anytime
- How-to Videos & Comprehensive Individual Component Manuals
- Live Search Box & Favorites Settings for Quick Reference
- View it Off-line After the Initial Download
- Product Warranty Information



MOBILE
You are on-the-go.
Your owner's manuals
should be too.



DYNAMIC
Instant updating
means your manual
is always current.



LIVE SEARCH
The information you're
looking for, right at
your fingertips.

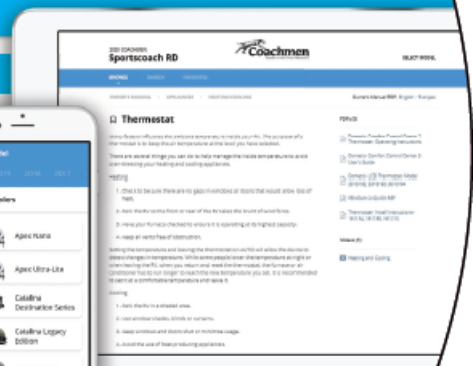

ACCESS YOUR OWNER'S MANUAL TWO WAYS:

Online at www.coachmenrv.com/owners or by downloading the **Coachmen RV Owner's Guide App** from Google Play or App Store on your mobile device.



Owner's Manuals & Product Warranty
also available via:
Forest River Owner's Relations
423 N. Main St., Middlebury, IN 46540
www.coachmenrv.com/owners
(574) 825-7000

MIRADA

BY COACHMEN

SELECT SUPPLIERS HAVE WARRANTIES THAT ARE HANDLED DIRECTLY BY THEIR SERVICE PROFESSIONALS. THE FOLLOWING IS A GUIDELINE OF THE PARTNERS WE UTILIZE:

COMPONENT	SUPPLIER'S LIMITED WARRANTY:
STRUCTURE	1 YEAR
FIT & FINISH	1 YEAR
NPS GENERATOR	3 YEARS
SHAW FLOORING	3 YEARS
APPLIANCES	1 YEAR
SOLAR SHADES	1 YEAR
LIPPERT SLIDE	1 YEAR
LIPPERT HYDRAULIC JACKS	1 YEAR
TREAD LITE POWER STEP	1 YEAR
GE AIR CONDITIONER	2 YEARS
ATWOOD FURNACE	2 YEARS
ATWOOD WATER HEATER	2 YEARS
FIBERGLASS ROOF SKIN	2 YEAR
Noble Select Side Walls	3 YEARS
WILLIAMSBURG DRIVER AND PASSENGER SEATS	2 YEARS
TELEVISIONS	1 YEAR
FORD POWERTRAIN	5 YEAR or 60,000 MILES/96,560 Kilometers
FORD CHASSIS	3 YEAR or 36,000 MILES/57,936 Kilometers



Service & Parts Contacts for Coachmen Class A Motorhomes

Scott Shinall
Customer Service Manager
574-825-8212
sshinall@forestriverinc.com

Linda Aleman
Customer Service Representative
574-825-8317
laleman@forestriverinc.com

Amber Oswald
Customer Parts Representative
574-825-8663
sshinall@forestriverinc.com

*All information contained in this training packet is believed to be accurate at the time of publication. However, during the model year, it may be necessary to make revisions and Coachmen reserves the right to make all such changes without notice, including prices, colors, materials, equipment and specifications as well as the addition of new models and the discontinuance of models shown in this brochure. Therefore, please consult with your Coachmen dealer and confirm the existence of any materials, design or specifications that are material to your purchase decision. 12/21

©Copyright 2021 Coachmen RV a Division of Forest River Inc. – All Rights Reserved.

Coachmen History

The first Coachmen RV products were manufactured in a 5,000 square foot plant in downtown Middlebury, Indiana, by Coachmen Industries, a company founded by three brothers: Tom, Keith and Claude Corson.

Coachmen's first year of production totaled 12 travel trailers, a single truck camper and 80 truck caps. Since then, over three quarters of a million Coachmen recreational vehicles have been produced and sold.

In December of 2008, Coachmen RV became a proud brand of Forest River, Inc., a Berkshire Hathaway company.

Today - Coachmen RV, a division of Forest River, Inc., is headquartered in Middlebury, Indiana, with our primary manufacturing facilities occupying over 220 acres with more than 23 acres under roof serving as dedicated manufacturing facilities for Coachmen branded Class A Motorhomes, Class C Motorhomes, Fifth Wheels and Travel Trailers. Our Camping Trailers are manufactured in our Centerville, Michigan, manufacturing facilities occupying 90 acres.

A Brand You Can Trust!

Coachmen RV products have been on North American roads and in North American campgrounds since 1964.

With over five decades of building Recreational Vehicles and over 600,000 RVs built and sold we know how to design and build a reliable RV with exceptional value, dependable design, practical innovation and the comforts and features you desire.